

THIS DRAWING IS UNPUBLISHED. RELEASED FOR PUBLICATION SEP, 2005.

© COPYRIGHT 2005 BY TYCO ELECTRONICS CORPORATION. ALL RIGHTS RESERVED.

| LOC | DIST | REVISIONS | | | | | |
|-----|------|-----------|-----|---------------|---------|-----|------|
| E | B | P | LTR | DESCRIPTION | DATE | DWN | APVD |
| | | C | | ECR-05-010526 | 14SEP05 | JMS | FWK |

NOTES:

- ① PACK IN ACCORDANCE WITH AMP SPEC 107-3275
- ② 100 TRAY PACK IN ACCORDANCE WITH AMP SPEC 107-3275
- ③ Au PLATING
- ④ Ni PLATING
- ⑤ THIS ITEM MUST BE WHITE

6. ELECTRICAL CHARACTERISTICS

FREQUENCY RANGE: DC - 11 GHz
 NOMINAL IMPEDANCE: 50 Ohm
 INSULATION RESISTANCE: 5000 MOhm
 WORKING VOLTAGE: 1000 Volts RMS at Sea Level
 DIELECTRIC WITHSTAND VOLTAGE: 2500 Volts RMS Max
 CONTACT RESISTANCE:
 CENTRE CONTACT: 1.00 mOhm Max
 OUTER CONTACT: 1.00 mOhm Max
 VSWR @ 4GHz: 1.30:1 Max
 INSERTION LOSS dB @ x 4 GHz: 0.30 Max

7. MECHANICAL CHARACTERISTICS

COUPLING NUT RETENTION FORCE: 445N Min
 CABLE RETENTION FORCE: 350N Min
 CLAMP NUT RECOMMENDED TORQUE: 4.5N
 DURABILITY: 500 Cycles Min

8. ENVIRONMENTAL CHARACTERISTICS

OPERATING TEMPERATURE: -65 to +165 DegC

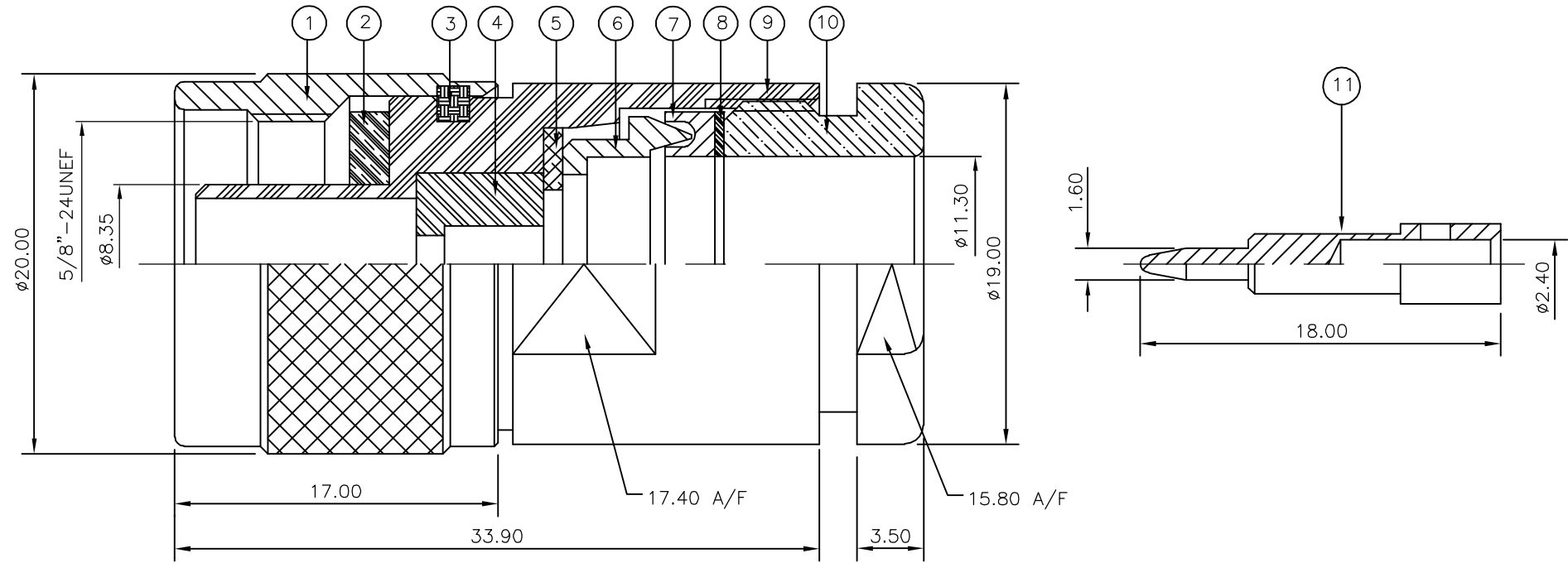

RECOMMENDED CABLE STRIPPING DIM'S

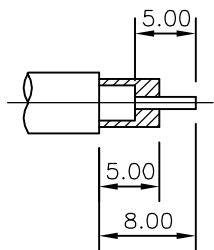

| | | | | | | |
|--|------|------|----------------|---|------------|-------------|
| | 1 | 1 | BRASS | ③ | CONTACT | 11 |
| | 1 | 1 | BRASS | ④ | CLAMP NUT | 10 |
| | 1 | 1 | BRASS | ④ | BODY | 9 |
| | 1 | 1 | BRASS | ④ | WASHER | 8 |
| | 1 | 1 | SILICON RUBBER | ⑤ | GASKET | 7 |
| | 1 | 1 | BRASS | ④ | SLEEVE | 6 |
| | 1 | 1 | BRASS | ④ | WASHER | 5 |
| | 1 | 1 | PTFE | | INSULATION | 4 |
| | 1 | 1 | BRASS | ④ | CIRCLIP | 3 |
| | 1 | 1 | SILICON RUBBER | ⑤ | GASKET | 2 |
| | 1 | 1 | BRASS | ④ | SHELL | 1 |
| | 6--0 | 1--0 | | | MATERIAL | DESCRIPTION |
| | | | | | | ITEM |

| | | | |
|-----------------------------|-----------------|-------------------------------------|--------------------|
| QUANTITY PER ASSY | | PARTS LIST | |
| DWN J.SANDWELL 14SEP05 | | Tyco Electronics Corporation | |
| CHK S.PARLOW 14SEP05 | | Bideford EX39 4HE | |
| APVD F.WHEELER-KING 14SEP05 | | NAME | |
| PRODUCT SPEC 108-3435 | | TYPE-N STRAIGHT PLUG SOLDER 50 OHM | |
| APPLICATION SPEC 411-3252 | | PSF 1/4M, RG8A/U, 213/U, URM67, KX4 | |
| SIZE A3 | CAGE CODE 00779 | DRAWING NO C-1337400 | RESTRICTED TO - |
| CUSTOMER DRAWING | | SCALE NTS | SHEET 1 OF 1 REV C |

| | |
|--|--|
| THIS DRAWING IS A CONTROLLED DOCUMENT. | |
| DIMENSIONS: mm | TOLERANCES UNLESS OTHERWISE SPECIFIED: |
| | 0 PLC ± - |
| | 1 PLC ± - |
| | 2 PLC ± - |
| | 3 PLC ± - |
| | 4 PLC ± - |
| | ANGLES ± - |
| MATERIAL SEE TABLE | FINISH SEE TABLE |